

LNG – Liquefied Natural Gas – is the
efficient new „green“ fuel

Build the future, prepare for LNG



Manufacturing safe and
innovative quality products

Your LNG partner:



LNG Vent Connections



Male Quick Disconnect Vent Metric

Part Number: 14000

Description

Male Quick Disconnect Vent
Metric in US, M20 x 1.5 Bulkhead

Flow capacity

10 GPM

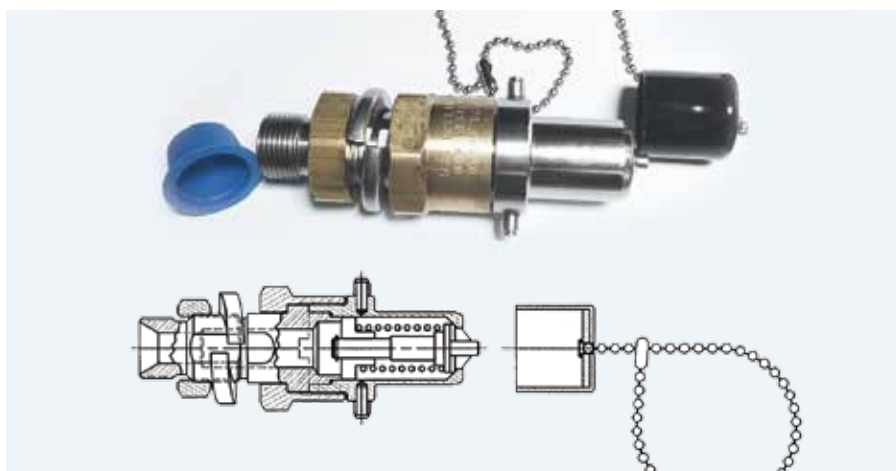

Male Quick Disconnect Vent Bulkhead

Part Number: 12895

Description

Male Quick Disconnect Vent
Bulkhead 3/8 Npt End conn.

Flow capacity

10 GPM

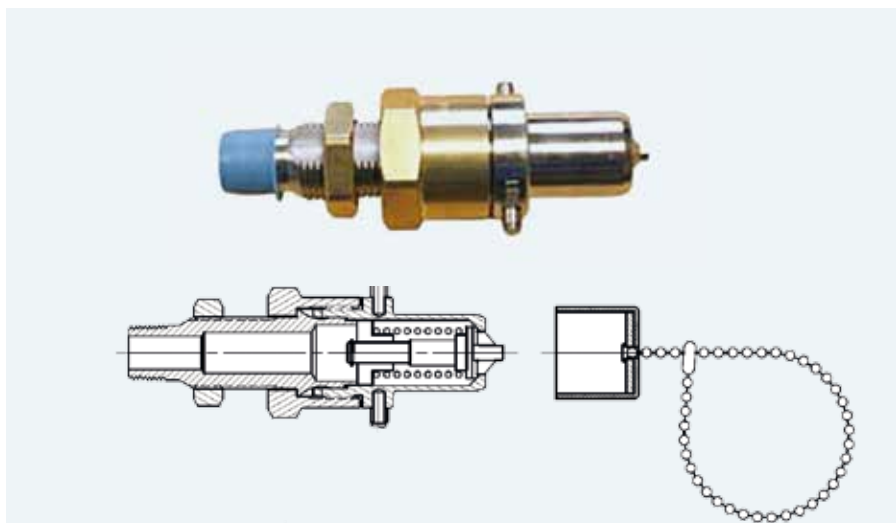

Male Quick Disconnect Vent Bulkhead Tube conn.

Part Number: 12895-1

Description

Male Quick Disconnect Vent
Bulkhead 3/8 Npt Tube conn. Ø .375
tube size ("Swagelok" tube fitting
equivalent)

Flow capacity

10 GPM

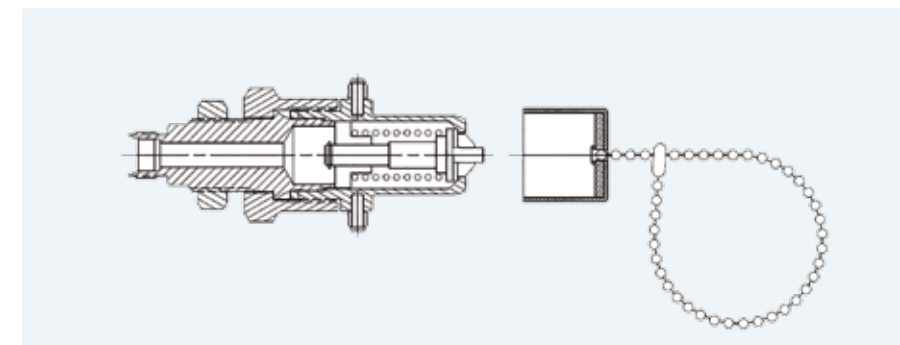

Male Quick Disconnect Vent End conn.

Part Number: 12680

Description

Male Quick Disconnect Vent
3/8 NPT End conn.

Flow capacity

10 GPM

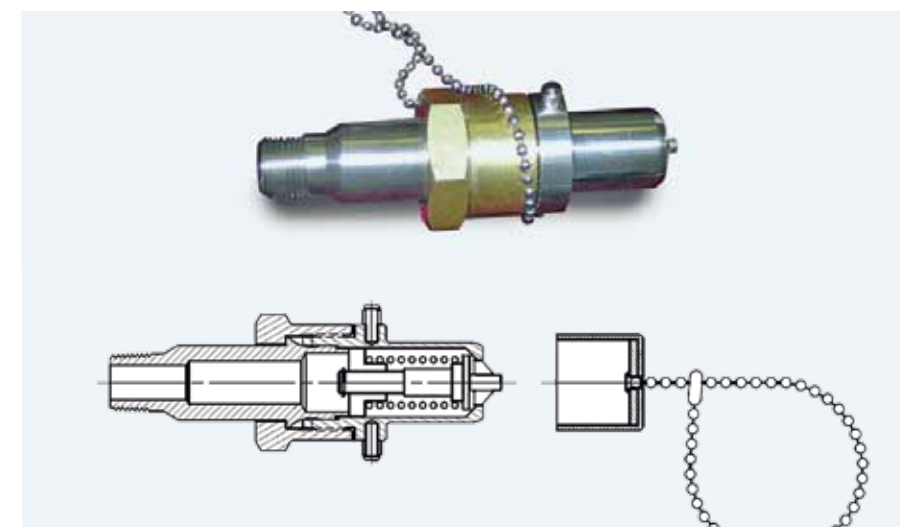

Male Socket Weld

Part Number: 11170

Description

Male with 3/8 pipe socket weld

Flow capacity

10 GPM

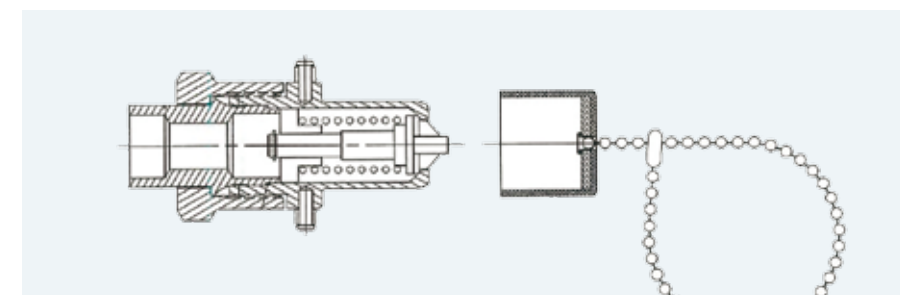

Repair Kit

Part Number: 11170-1

Description

Repair Kit for 11170, 12680, 12895

Black plastic Cap cover

Part Number: 12524-1

Description

Black plastic Cap cover and chain assembly for Male QDV vent

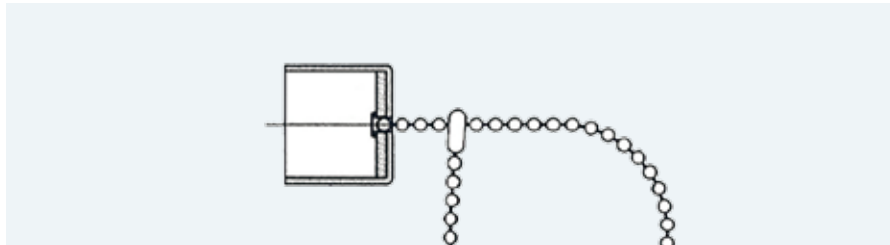

Male Fuelling Receptacle 37°

Part Number: 14410

Description

Male Fuelling Receptacle 37° SAE flare fitting with holding plate, "posilock" anti-rotation system and aluminum anodized clear cap cover

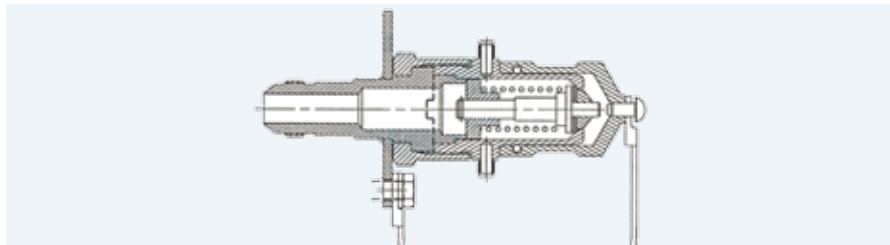

Blue Aluminum Cover Cap

Part Number: 13675

Description

Aluminum anodized blue Cap cover and lanyard assembly for Male QDV vent

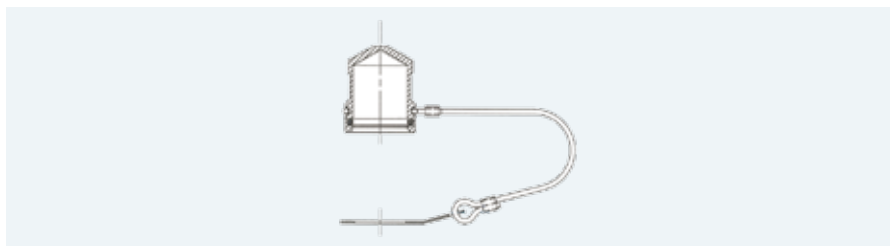

Male Quick Disconnect Vent Poppets-leakdown

Part Number: 13937

Description

Male Quick Disconnect Vent Poppets-leakdown

Flow capacity

10 GPM

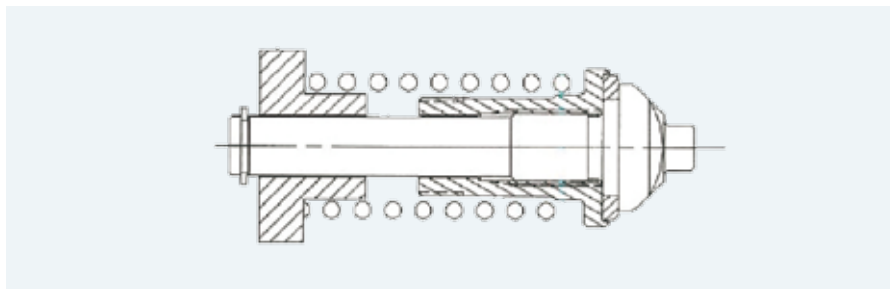

Female Quick Disconnect Vent, 90°

Part Number: 11175

Description

Female Quick Disconnect Vent, 10 GPM/Vent, 90deg. 5/8 tube size, 45deg SAE fitting end (CGA 440 ref)

Flow capacity

10 GPM



Female Quick Disconnect Vent

Part Number: 13775

Description

Female Quick Disconnect Vent, 10 GPM/Vent, Short Straight Handle (Cryogenic Swivel Part No. 9551-3 required) 5/8 tube size, 45deg SAE fitting end (CGA 440 ref)

Flow capacity

10 GPM



Long Female Quick Disconnect Vent

Part Number: 13785

Description

Female Quick Disconnect Vent, 10 GPM/Vent, Long Straight Handle (Cryogenic Swivel Part No. 9551-3 required) – 5/8 tube size, 45deg SAE fitting end (CGA 440 ref)

Flow capacity

10 GPM

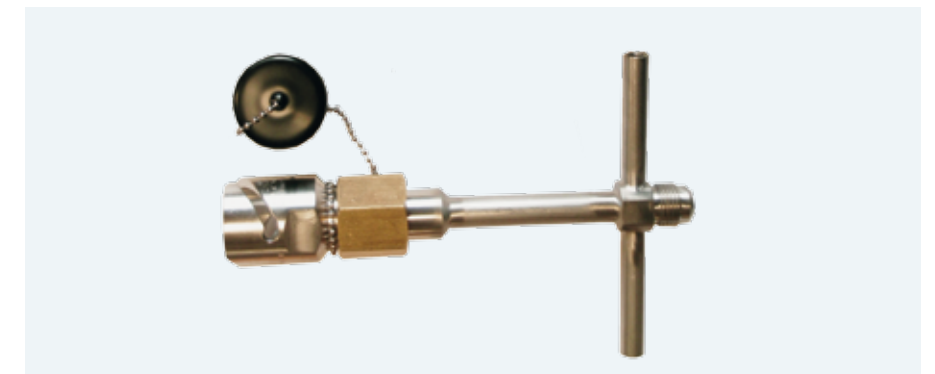

Vent Thread Ring Tool

Part Number: T-1948

Description

Vent Thread Ring Tool for Quick Disconnect Vent Female



Repair Kit for Quick Disconnect Vent Female

Part Number: 11175-2

Description

Repair Kit for Quick Disconnect Vent Female containing #14535 Poppet Assembly, #11173 Seal and 11093 Seal Assembly

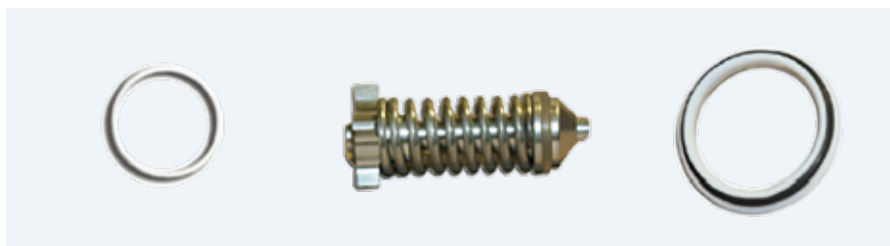

Seal Kit for Quick Disconnect Vent Female

Part Number: 11093

Description

Seal Kit for Quick Disconnect Vent Female



Poppet Assembly for Quick Disconnect Vent Female

Part Number: 14535

Description

Poppet Assembly for Quick Disconnect Vent Female

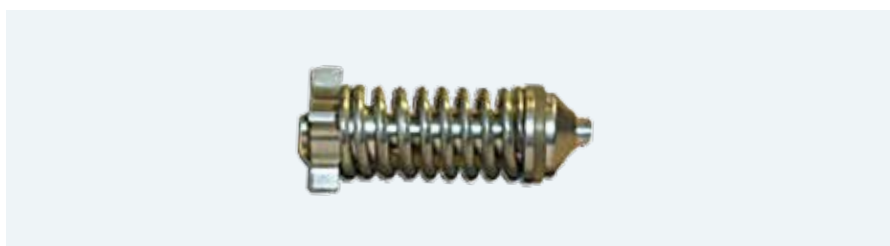

Body Seal for Quick Disconnect Vent Male/Female

Part Number: 11173

Description

Body Seal for Quick Disconnect Vent Male/Female



LNG Fill Connections



Male Fuelling Receptacle

Part Number: 13615

Description

Male Fuelling Receptacle with inlet 3/4" OD tube with double-ferrule fitting like "Swagelok" and "SSP Duolok"

Flow capacity

50 GPM

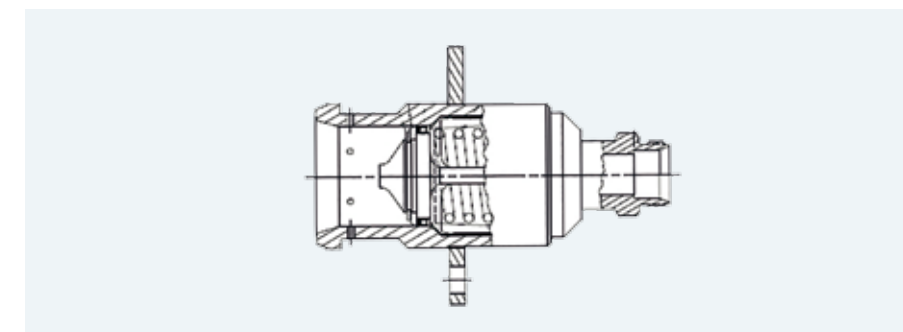

Male Fuelling Receptacle

Part Number: 14120

Description

Male Fuelling Receptacle with inlet 3/4" OD tube with double-ferrule fitting like "Swagelok" and "SSP Duolok"

Flow capacity

50 GPM

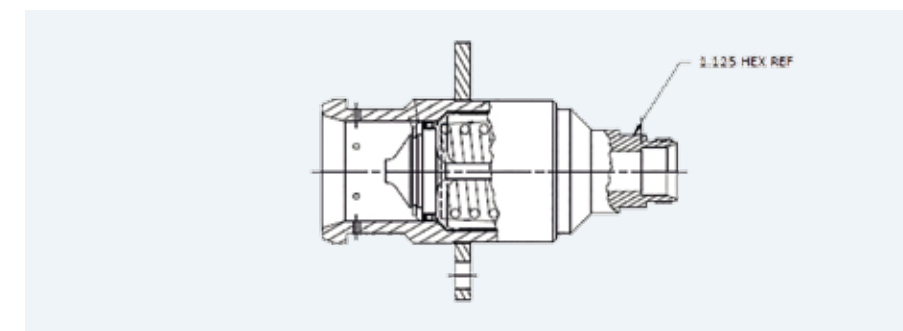

Male Fuelling Receptacle with inlet 3/4" NPTF

Part Number: 13620

Description

Male Fuelling Receptacle with inlet 3/4" NPTF

Flow capacity

50 GPM

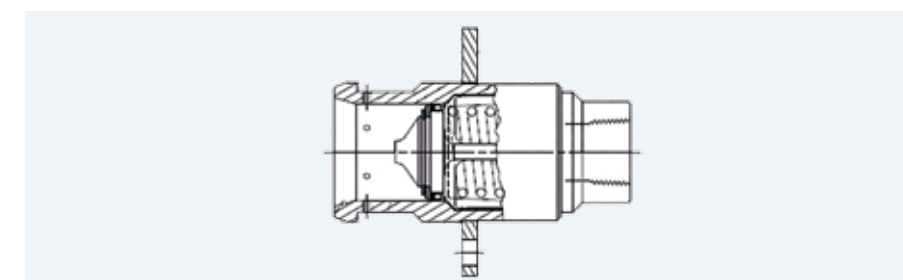

Male Fuelling Receptacle with 90° inlet

Part Number: 13705

Description

Male Fuelling Receptacle with 90° inlet for 3/4" OD tube with double-ferrule fitting like "Swagelok" and "SSP Duolok"

Flow capacity

50 GPM

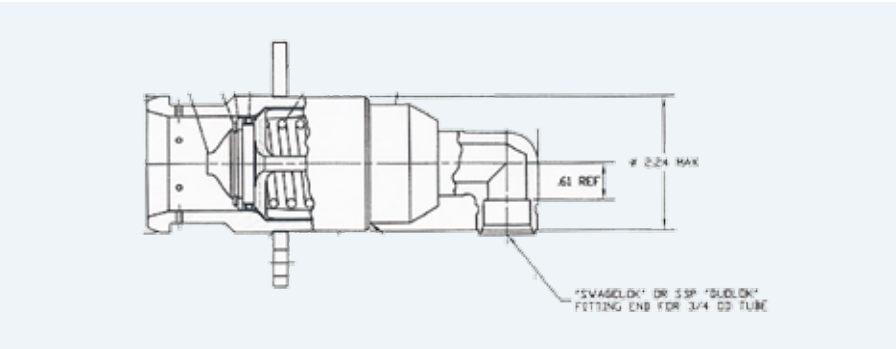

Male Fuelling Receptacle 37° SAE flare fitting

Part Number: 14405

Description

Male Fuelling Receptacle 37° SAE flare fitting

Flow capacity

50 GPM

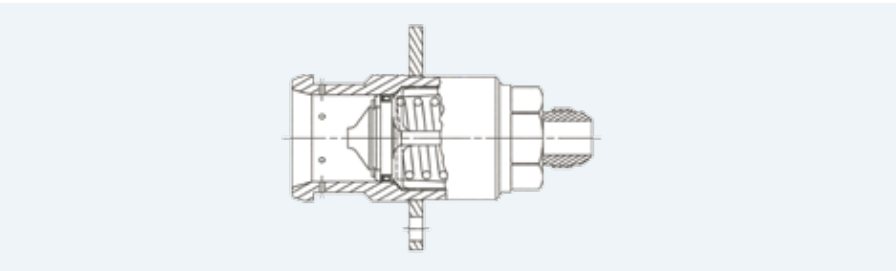

Male Fuelling Receptacle M30x1.5

Part Number: 13990

Description

Male Fuelling Receptacle M30x1.5 thread metric tube fitting

Flow capacity

50 GPM

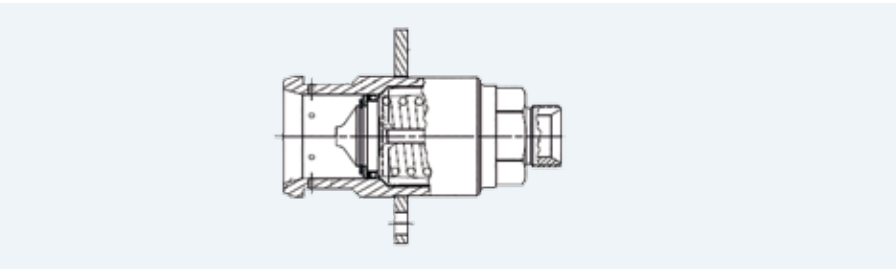

Male Fuelling Receptacle M30x2.0 THD

Part Number: 14050

Description

Male Fuelling Receptacle M30x2.0 THD thread metric tube fitting

Flow capacity

50 GPM

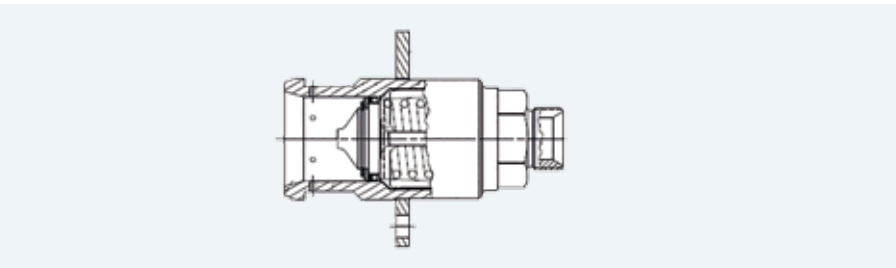

Aluminum Cap for 50 GPM Male Fuelling Receptacle

Part Number: 13665

Description

Aluminum Cap for 50 GPM Male Fuelling Receptacle

Flow capacity

50 GPM



Dock, Fuelling Nozzle Receptacle

Part Number: 13685

Description

Dock, Fuelling Nozzle Receptacle

Flow capacity

50 GPM

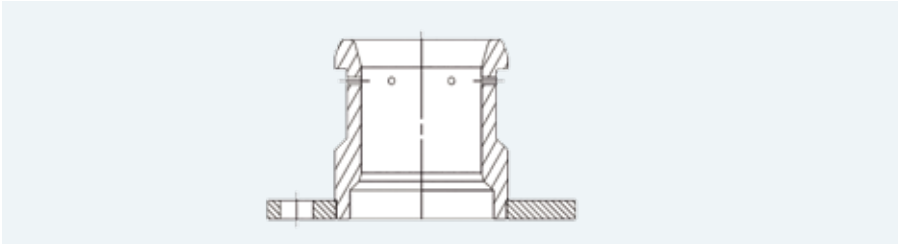

Dock, Fuelling Nozzle Receptacle closed-end

Part Number: 14237

Description

Dock, Fuelling Nozzle Receptacle

Flow capacity

50 GPM

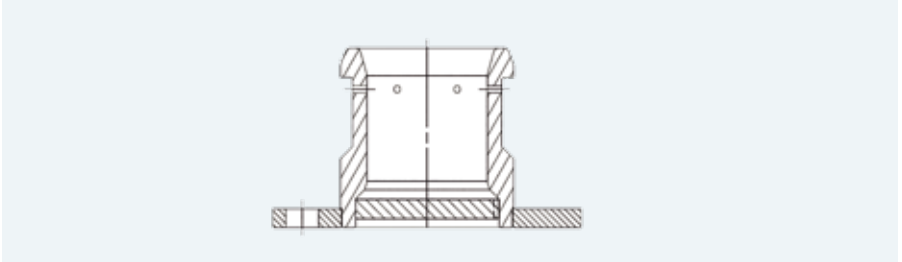

Repair Kit for Male Fuelling Receptacle

Part Number: T-3003

Description

Repair Kit for Male Fuelling Receptacle

Seal for Male Fuelling Receptacle (Obsolete)

Part Number: 14010

Description

Seal for Male Fuelling Receptacle (OBSOLETE - USE NEW P/N 14508)

Seal for Male Fuelling Receptacle

Part Number: 14596

Description

Seal for Male Fuelling Receptacle

LNG Vent / Fill Cryogenic Hoses

1/2" ID Bulk Hose – venting line 72" (1,80 m)

Part Number: CHB-440-440-072

Description

1/2" ID Bulk Hose - venting line 72" (1,80m) Brass connections 5/8 45° SAE

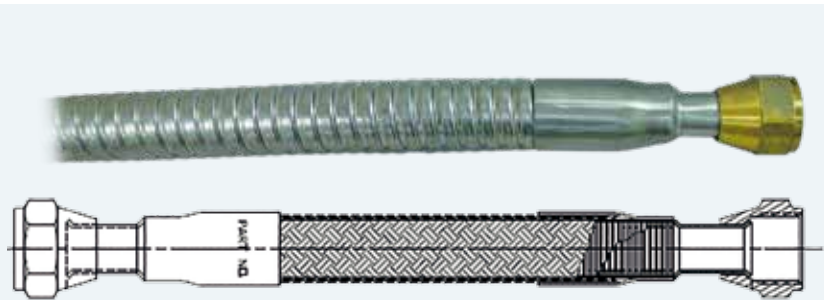

1/2" ID Bulk Hose – venting line 96" (2,40 m)

Part Number: CHB-440-440-096

Description

1/2" ID Bulk Hose - venting line 96" (2,40m) Brass connections 5/8 45° SAE

1/2" ID Bulk Hose – venting line 120" (3 m)

Part Number: CHB-440-440-120

Description

1/2" ID Bulk Hose - venting line 120" (3m) Brass connections 5/8 45° SAE

1/2" ID Bulk Hose – venting line 144" (3,60 m)

Part Number: CHB-440-440-144

Description

1/2" ID Bulk Hose - venting line 144" (3,60m) Brass connections 5/8 45° SAE

1/2" ID Bulk Hose – venting line 156" (3,90 m)

Part Number: CHB-440-440-156

Description

1/2" ID Bulk Hose - venting line 156" (3,90m) Brass connections 5/8 45° SAE

1/2" ID Bulk Hose - venting line 180" (4,50m)

Part Number: CHB-440-440-180

Description

1/2" ID Bulk Hose - venting line 180" (4,50m) Brass connections 5/8 45° SAE

1/2" ID Bulk Hose - venting line 72" (1,80 m) Stainless Steel connections

Part Number: CHS-440-440-072

Description

1/2" ID Bulk Hose - venting line 72" (1,80m) Stainless Steel connections 5/8 45° SAE



1/2" ID Bulk Hose – venting line 96" (2,40 m)

Part Number: CHS-440-440-096

Description

1/2" ID Bulk Hose - venting line 96" (2,40m) Stainless Steel connections 5/8 45° SAE

1/2" ID Bulk Hose – venting line 120" (3 m)

Part Number: CHS-440-440-120

Description

1/2" ID Bulk Hose - venting line 120" (3m) Stainless Steel connections 5/8 45° SAE

1/2" ID Bulk Hose – venting line 144" (3,60 m)

Part Number: CHS-440-440-144

Description

1/2" ID Bulk Hose - venting line 144" (3,60m) Stainless Steel connections 5/8 45° SAE

1" ID Bulk Hose – liquid line 72" (1,80 m)

Part Number: 11910-072

Description

1" ID Bulk Hose - liquid line 72" (1,80m) Stainless Steel connections SAE J514, 37° Flare JIC

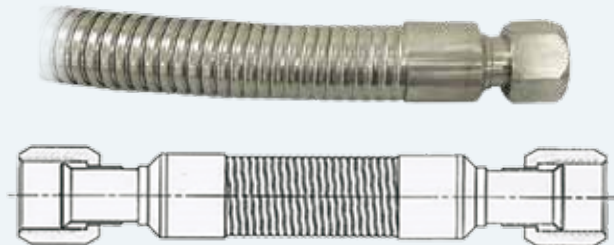

1" ID Bulk Hose - liquid line 120" (3 m)

Part Number: 11910-120

Description

1" ID Bulk Hose - liquid line 120" (3m) Stainless Steel connections SAE J514, 37° Flare JIC

1" ID Bulk Hose - liquid line 144" (3,60 m)

Part Number: 11910-144

Description

1" ID Bulk Hose - liquid line 144" (3,60m) Stainless Steel connections

1" ID Bulk Hose - liquid line 180" (4,50 m)

Part Number: 11910-180

Description

1" ID Bulk Hose - liquid line 180" (4,50m) Stainless Steel connections

1" ID Bulk Hose - liquid line 120" (3 m) Stainless Steel

Part Number: 14340-120

Description

1" ID Bulk Hose - liquid line 120" (3m) Stainless Steel connections WITH double armor (reinforced ends) SAE J514, 37° Flare JIC



1" ID Bulk Hose - liquid line 144" (3,60 m) Stainless Steel

Part Number: 14340-144

Description

1" ID Bulk Hose - liquid line 144" (3,60m) Stainless Steel connections WITH double armor (reinforced ends) SAE J514, 37° Flare JIC

1" ID Bulk Hose - liquid line 156" (3,90 m) Stainless Steel

Part Number: 14340-156

Description

1" ID Bulk Hose - liquid line 156" (3,90m) Stainless Steel connections WITH double armor (reinforced ends) SAE J514, 37° Flare JIC

1" ID Bulk Hose - liquid line 180" (4,50 m) Stainless Steel

Part Number: 14340-180

Description

1" ID Bulk Hose - liquid line 180" (4,50m) Stainless Steel connections WITH double armor (reinforced ends) SAE J514, 37° Flare JIC

1" ID Bulk Hose - liquid line 240" (6 m) Stainless Steel

Part Number: 14340-240

Description

1" ID Bulk Hose - liquid line 240" (6m) Stainless Steel connections WITH double armor (reinforced ends) SAE J514, 37° Flare JIC

Swivel 45° male SAE fitting for 5/8 OD Tube, 5/8" SAE 45° female

Part Number: 9551-3

WARNING

when using the swivel in an installation with any kind of side-loading there is a known risk of leakage

Part Number: 9551-RK

Repair kit for Swivel

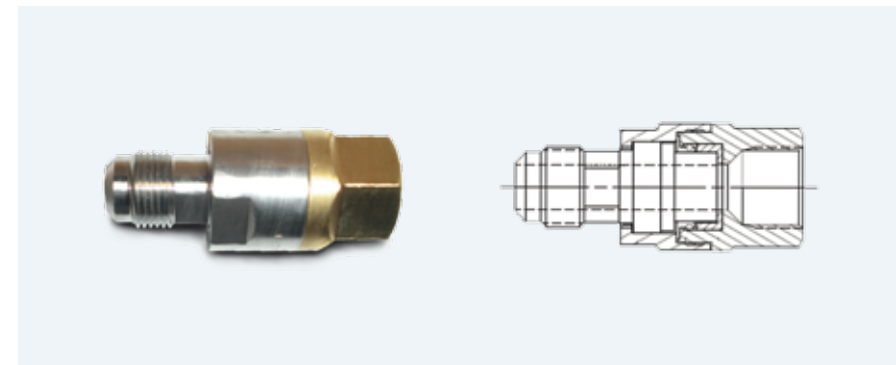

Hose Adapter 1" JIC Female x 5/8 SAE Male

Part Number: 12275

Description

(Flare tubing adapter 1" 37° SAE FEMALE to 5/8 45° SAE MALE)

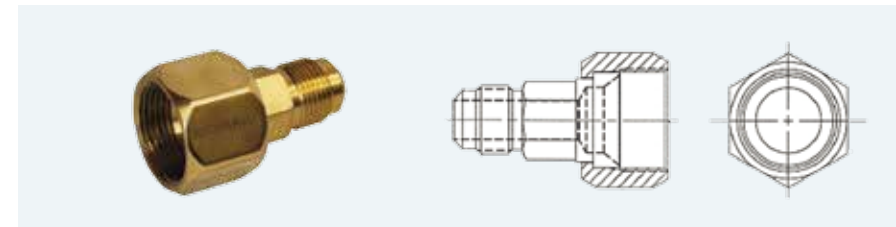

Copper Cone Seal for Bulk Hose connections

Part Number: 10719-09

Description

Copper Cone Seal for 1/2" Bulk Hose connections

Part Number: 10719-16

Description

Copper Cone Seal for 1" Bulk Hose connections



Brass Adapter

Part Number: B-290

Description

Brass Adapter, 1" male x 1/2" female (the use of 2 pcs, allow the installation of a 1" LNG liquide hose in the LNG venting line which commonly have 1/2" connections)



LNG Vent / Fill Breakaway

Breakaway, Vent for 1/2" ID Hose

Part Number: 14370

Description

Vent Breakaway (6" length) for 1/2" ID Hose. Hose Connection Fitting .975-14 UN-2A Thread for 5/8" SAE 45° Male Fitting End (JIC)

Dispenser Connection Fitting .75 - 14 MNPT RE. Includes 1/4"MNPT blanked-off air pressure fitting for pneumatic pressure switch



Breakaway 50 GPM Flow, Fill side Breakaway

Part Number: 14390-4

Description

Fill Breakaway short (7.25" length) 50 GPM Flow, 22.5' angled. Dispenser Connection Fitting, Ø 1" Tube size - 11.5 M NPT Hose Connection Fitting, 1.3125-12 UN-2A Thread for Ø 1" Tube size, 37° SAE fitting end

Does NOT include 1/4"MNPT blanked-off air pressure fitting for pneumatic pressure switch



Part Number: 14390-8

Description

Fill Breakaway short (7.25" length) 50 GPM Flow, 22.5' angled. Dispenser Connection Fitting, Ø1" Tube size - 11.5 M NPT Hose Connection Fitting, M36 x 2 THD.

Does NOT include 1/4"MNPT blanked-off air pressure fitting for pneumatic pressure switch

Part Number: 13740-4

Description

Fill Breakaway short (7.25" length) 50 GPM Flow. Dispenser Connection Fitting, Ø1" Tube size - 11.5 M NPT Hose Connection Fitting, 1.3125-12 UN-2A Thread for Ø 1" Tube size, 37° SAE fitting end

Includes 1/4"MNPT blanked-off air pressure fitting for pneumatic pressure switch

Part Number: 13740-8

Description

Fill Breakaway short (7.25" length) 50 GPM Flow. Dispenser Connection Fitting, Ø1" Tube size - 11.5 M NPT Hose Connection Fitting, M36 x 2 THD

Includes 1/4"MNPT blanked-off air pressure fitting for pneumatic pressure switch

Breakaway 50 GPM Flow, Fill side Breakaway

Part Number: 14390-2

Description

Fill Breakaway standard (10.50" length) 50 GPM Flow, 22.5' angled

Dispenser Connection Fitting, Ø 1" Tube size - 11.5 M NPT Hose Connection Fitting, 1.3125-12 UN-2A Thread for Ø 1" Tube size, 37° SAE fitting end. – Does NOT include 1/4"MNPT blanked-off air pressure fitting for pneumatic pressure switch



Part Number: 14390-6

Description

Fill Breakaway short (10.50" length) 50 GPM Flow, 22.5' angled. Dispenser Connection Fitting, Ø1" Tube size - 11.5 M NPT Hose Connection Fitting, M36 x 2 THD.

Does NOT include 1/4"MNPT blanked-off air pressure fitting for pneumatic pressure switch

Part Number: 13740-2

Description

Fill Breakaway standard (10.50" length) 50 GPM Flow, 22.5' angled. Dispenser Connection Fitting, Ø 1" Tube size - 11.5 M NPT Hose Connection Fitting, 1.3125-12 UN-2A Thread for Ø 1" Tube size, 37° SAE fitting end.

Includes 1/4"MNPT blanked-off air pressure fitting for pneumatic pressure switch

Part Number: 13740-6

Description

Fill Breakaway short (10.50" length) 50 GPM Flow, 22.5' angled. Dispenser Connection Fitting, Ø1" Tube size - 11.5 M NPT Hose Connection Fitting, M36 x 2 THD.

Includes 1/4"MNPT blanked-off air pressure fitting for pneumatic pressure switch

Breakaway 50 GPM Flow, Fill side Breakaway

Part Number: 14390-5

Description

Fill Breakaway standard (10.50" length) 50 GPM Flow, Straight NOT angled. Dispenser Connection Fitting, Ø 1" Tube size - 11.5 M NPT Hose Connection Fitting, 1.3125-12 UN-2A Thread for Ø 1" Tube size, 37° SAE fitting end

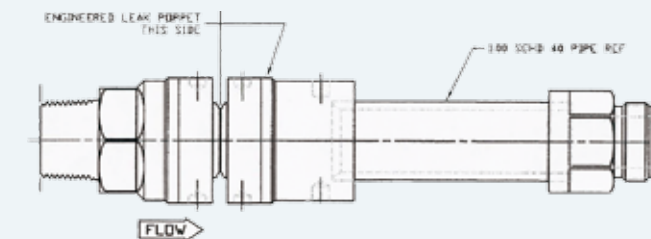

Does NOT include 1/4"MNPT blanked-off air pressure fitting for pneumatic pressure switch

Breakaway 50 GPM Flow, Fill side Breakaway

Part Number: 13740-5

Description

Fill Breakaway standard (10.50" length) 50 GPM Flow, Straight NOT angled. Dispenser Connection Fitting, Ø 1" Tube size - 11.5 M NPT Hose Connection Fitting, 1.3125-12 UN-2A Thread for Ø 1" Tube size, 37° SAE fitting end



Includes 1/4"MNPT blanked-off air pressure fitting for pneumatic pressure switch

Fuelling Nozzle 50 GPM



SAFE

REGO® CryoMac3 nozzle SAFETY feature is patented, certified and recognized in the market as a major failsafe advantage for the operator SAFETY.

Fuelling Nozzle CryoMac3-50M

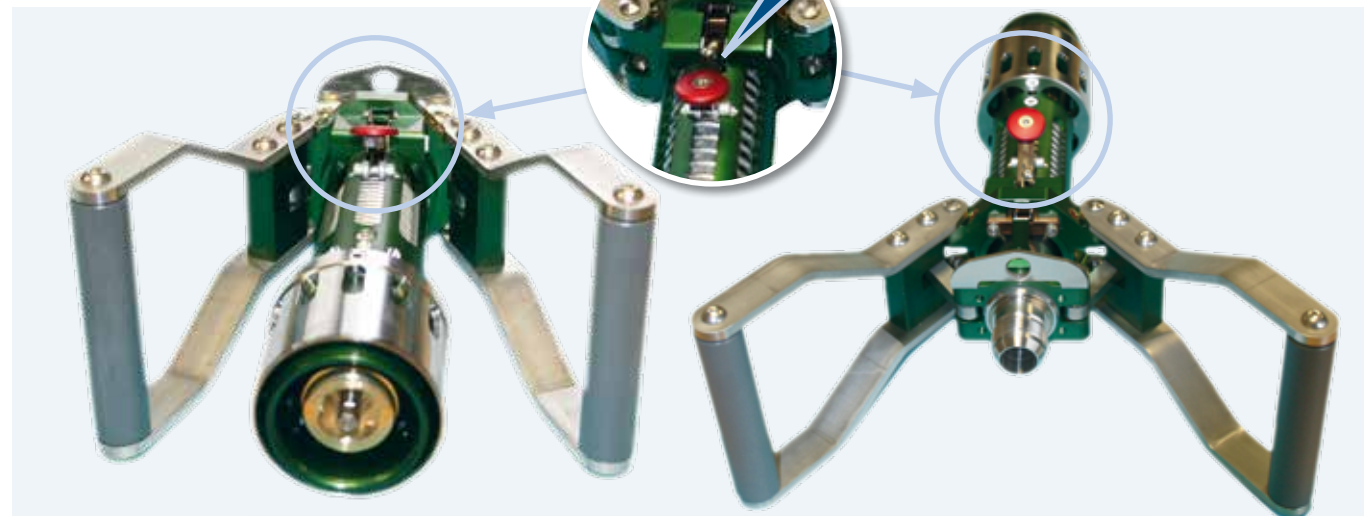

CERTIFIED

according to ISO 12617 approved product as specified by ISO 16924 Natural gas fuelling stations – LNG stations for fuelling vehicles

Part Number: CryoMac3-50M

Description

JIC Male SAE 37° Flare Fitting for 1" tube – Stand. Handle ISO 12617 Road Vehicles certified

Flow Capacity

50 GPM

Part Number: CryoMac3-50M-S

Description

JIC Male SAE 37° Flare Fitting for 1" tube - Short Handle ISO 12617 Road Vehicles certified

Flow Capacity

50 GPM

Sleeve Assembly for CryoMac3

Part Number: 14103

Description

Sleeve Assembly for CryoMac3 (sleeve, nose piece, 16 balls, 6 guide pins, and a rubber band)



Seat & Seal Assembly for CryoMac3

Part Number: 14255

Description

Seat & Seal Assembly for CryoMac3

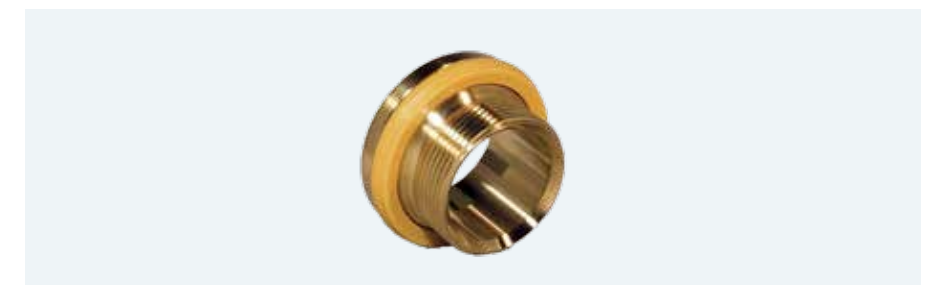

CryoMac3 Interface Seal replacement

Part Number: 14591

Description

CryoMac3 Interface Seal replacement (to ensure a correct seal replacement use tool kit p/n 14590)

Part Number: 14424

Description

CryoMac3 Interface Seal replacement – OBSOLETE VERSION (please use latest release p/n 14591)



CryoMac3 Seal Repair Tool Kit

Part Number: 14590

Description

CryoMac3 Seal Repair Tool Kit



Poppet Assembly for CryoMac3

Part Number: 13960

Description
Poppet Assembly for CryoMac3



Tool for poppet removal for CryoMac3

Part Number: T-2961

Description
Tool for poppet removal for CryoMac3





Partner for progress

Engineered Controls International, LLC
Burlington, North Carolina
United States of America

Kiwa Nederland B.V. hereby declares that the

CryoMac3 LNG nozzle,

Complies with the requirements of ISO12617:2016

Road vehicles
Liquefied natural gas (LNG) refuelling connector - 3,1 MPa connector

Issued by:



Paul Dijkhof,
Unit Manager Automotive, Kiwa Nederland B.V.

Kiwa Nederland B.V.
Wilmsdorf 50
P.O. Box 137
7300 AC APELDOORN
The Netherlands

Phone + 31 555 393 355
Fax + 31 555 393 685
www.1kiwa.com

Number
Issued
This declaration is issued on June 2nd, 2016 and is valid for the above mentioned product until the product is modified. All details of the modifications can be found in the report 150701344.
Page

150701344-ISO-01 Ext.:00
June 2nd, 2016

1-1

Page 19

REGO
EUROPE

Maximum safety for LNG fuel technology



Your LNG partner:

REGO
EUROPE



REGO GmbH is
ISO 9001 certified

REGO GmbH - Distribution Center Europe
Industriestrasse 9, 35075 Gladenbach, Germany
Phone +49 (0)6462-9147-0, Fax -9147-29 | info@rego-europe.de · www.rego-europe.de

REGO Trademarks



Macro
Technologies



Superior
Products